

30.

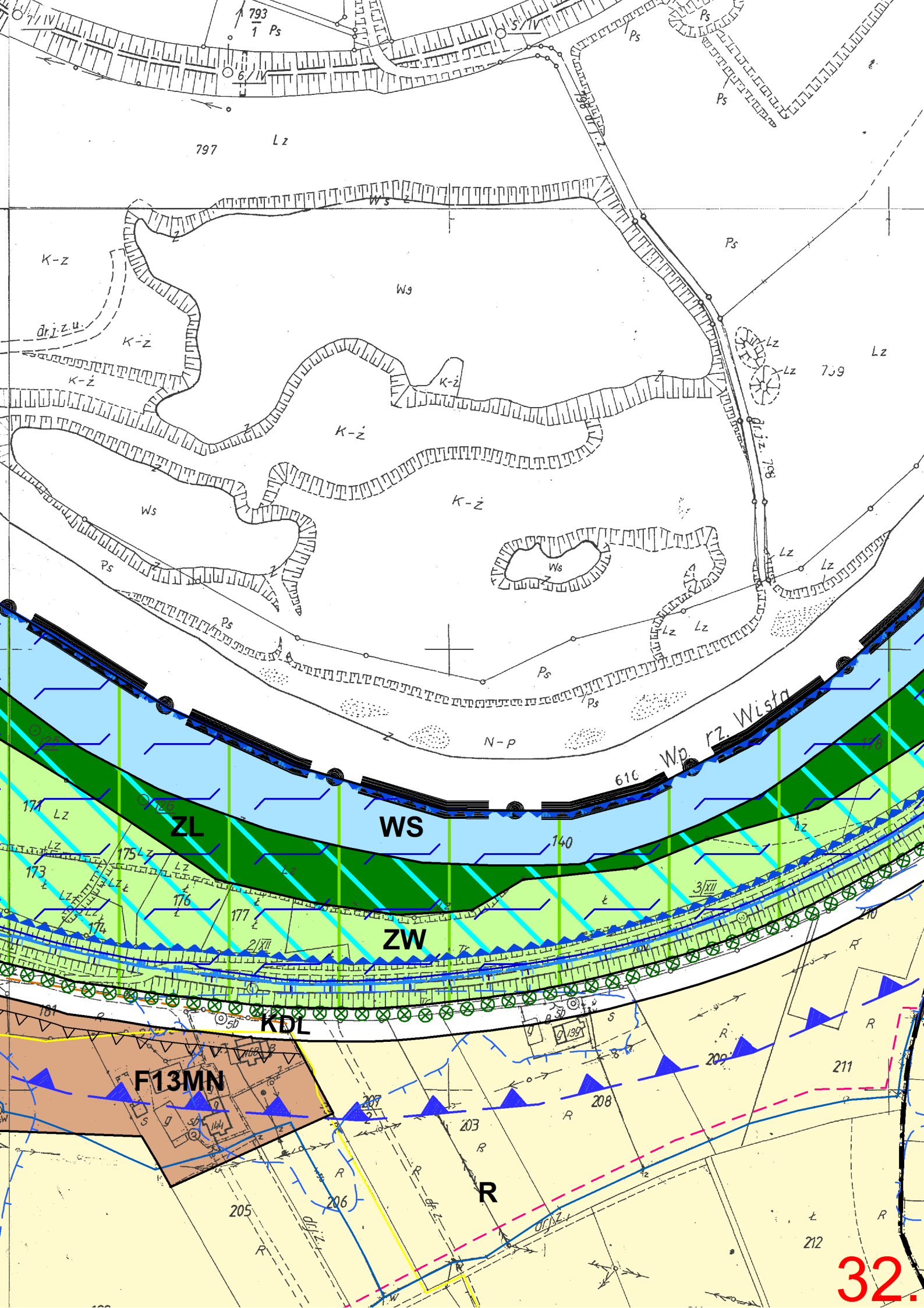

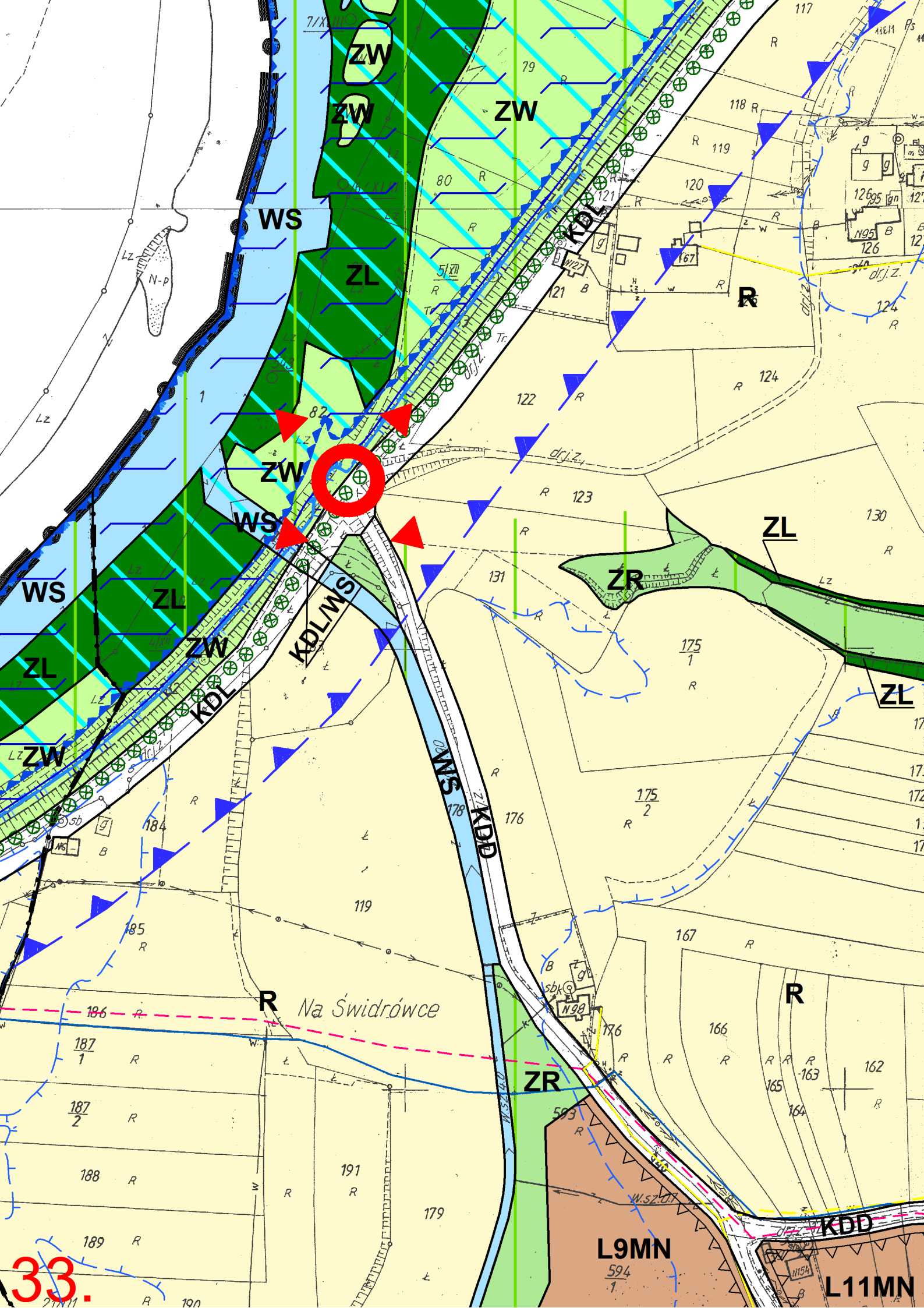

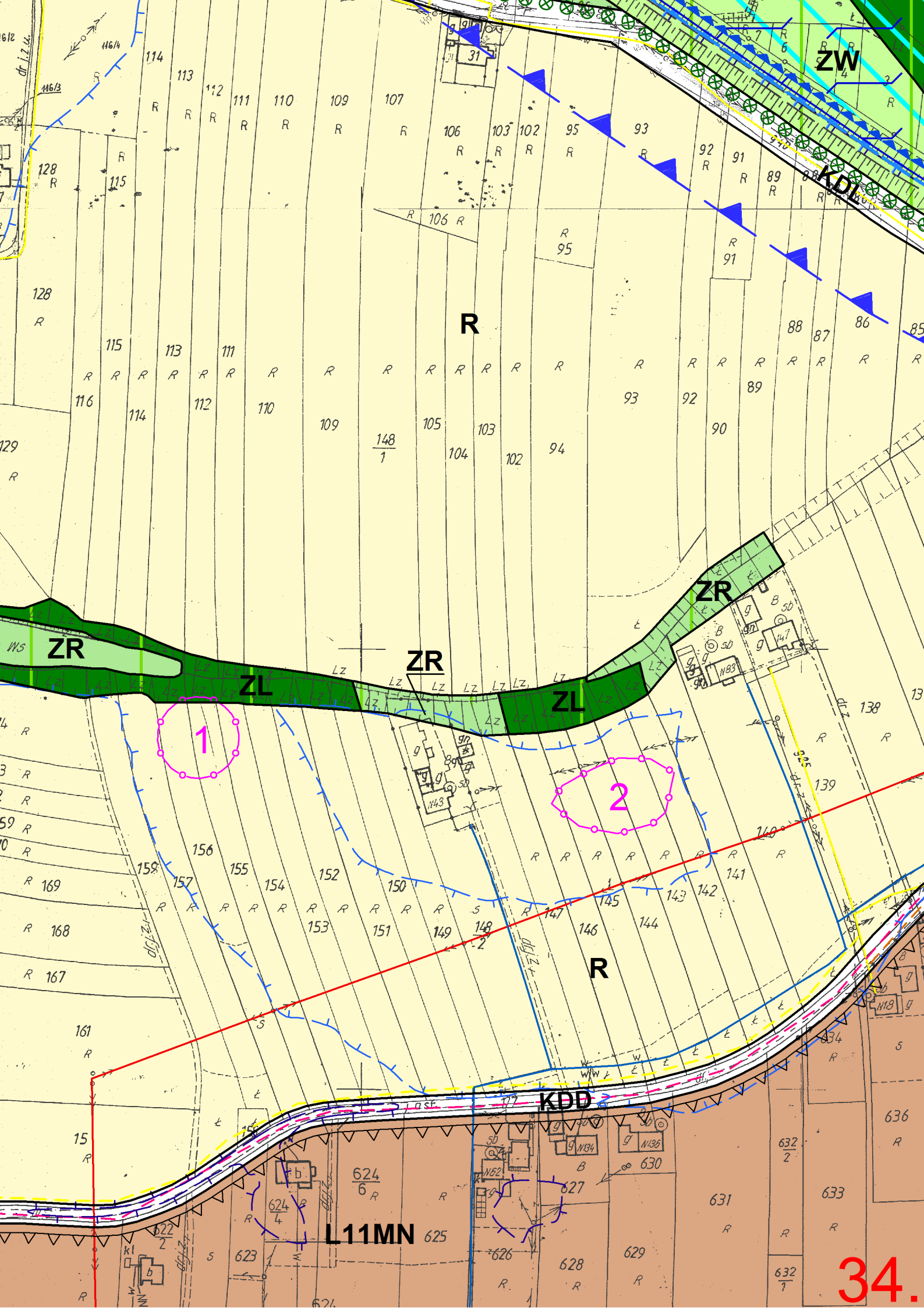

ZW

KDD

R

ZR

ZR

ZR

ZL

ZL

R

KDD

L11MN

34.

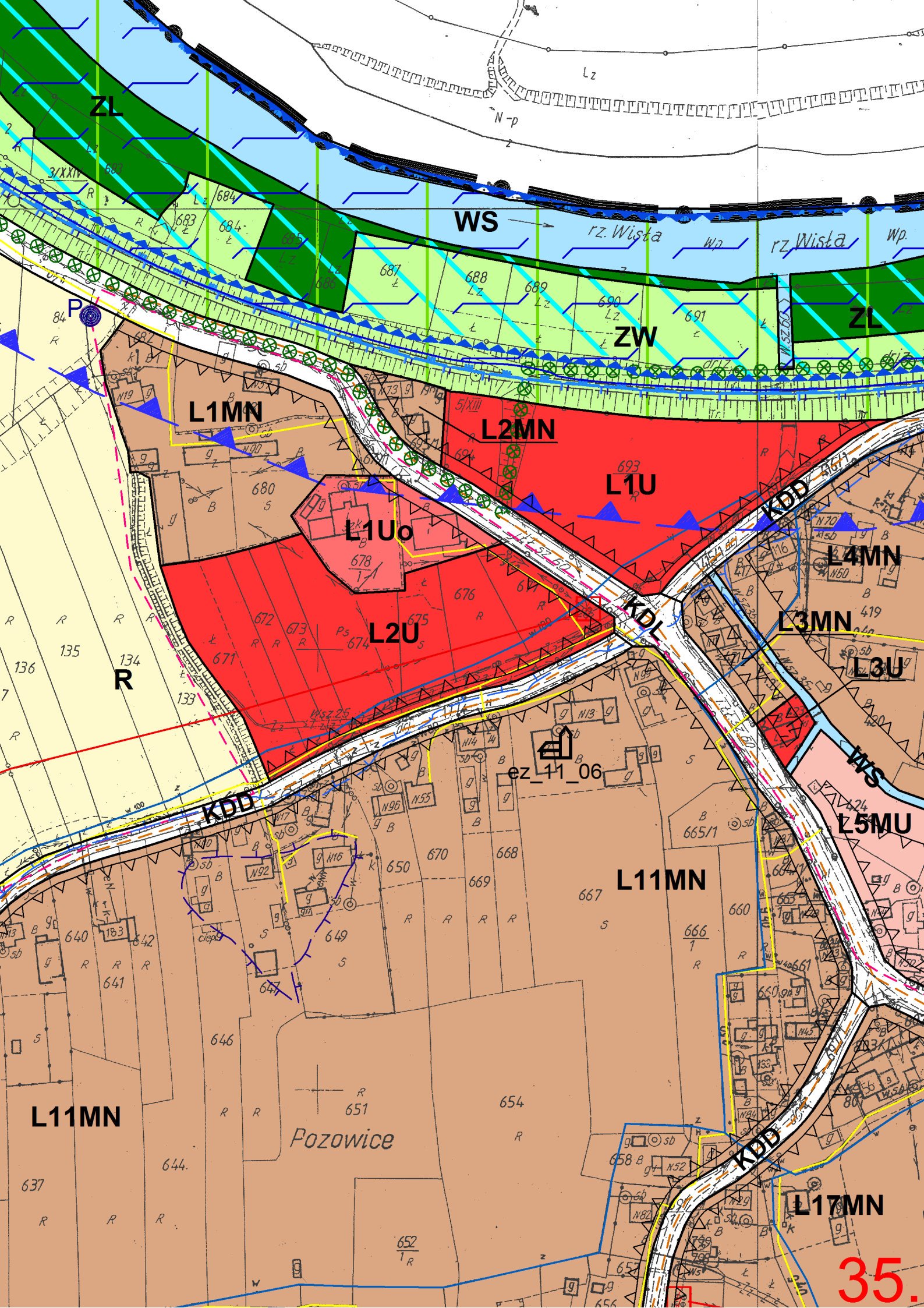

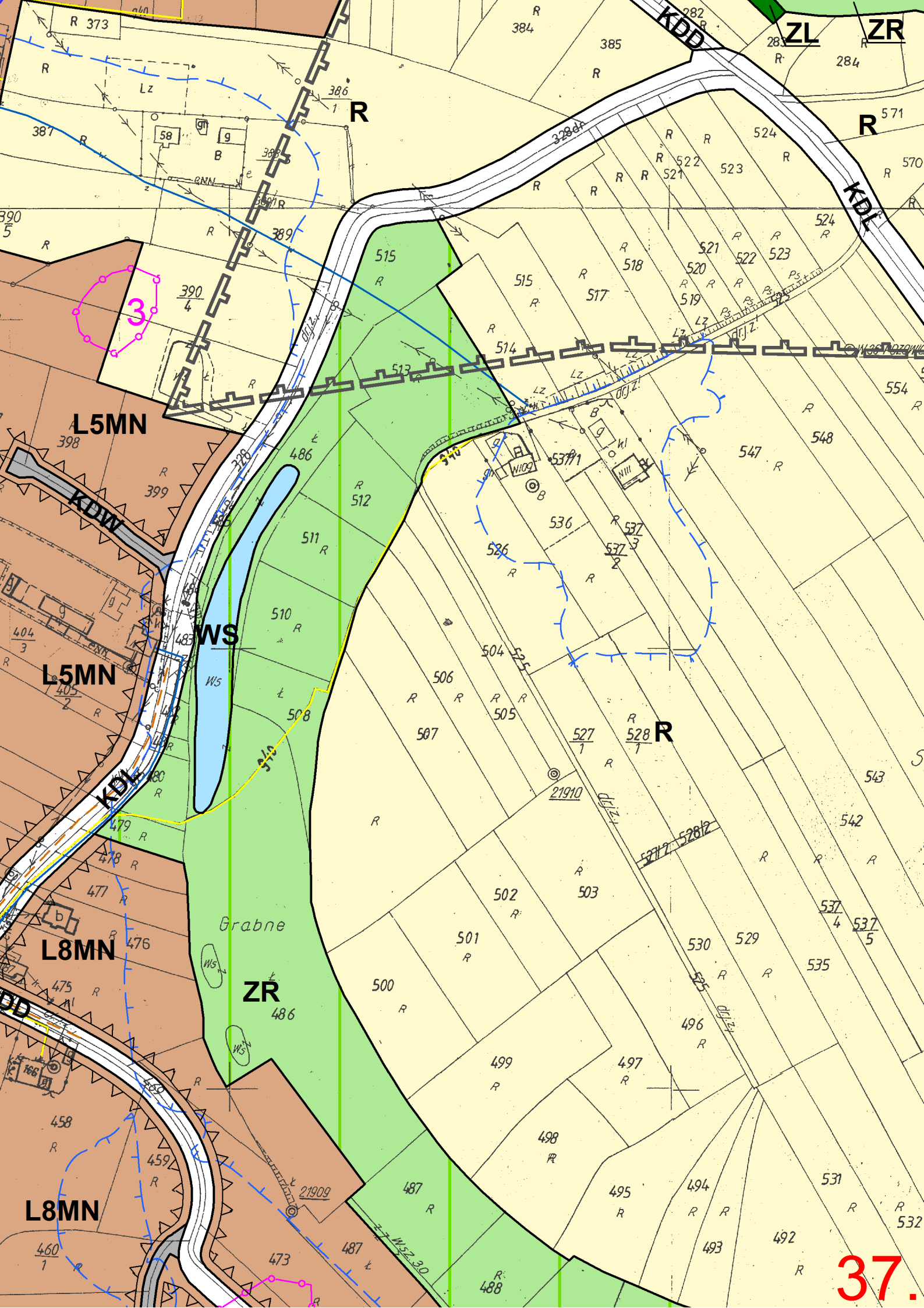

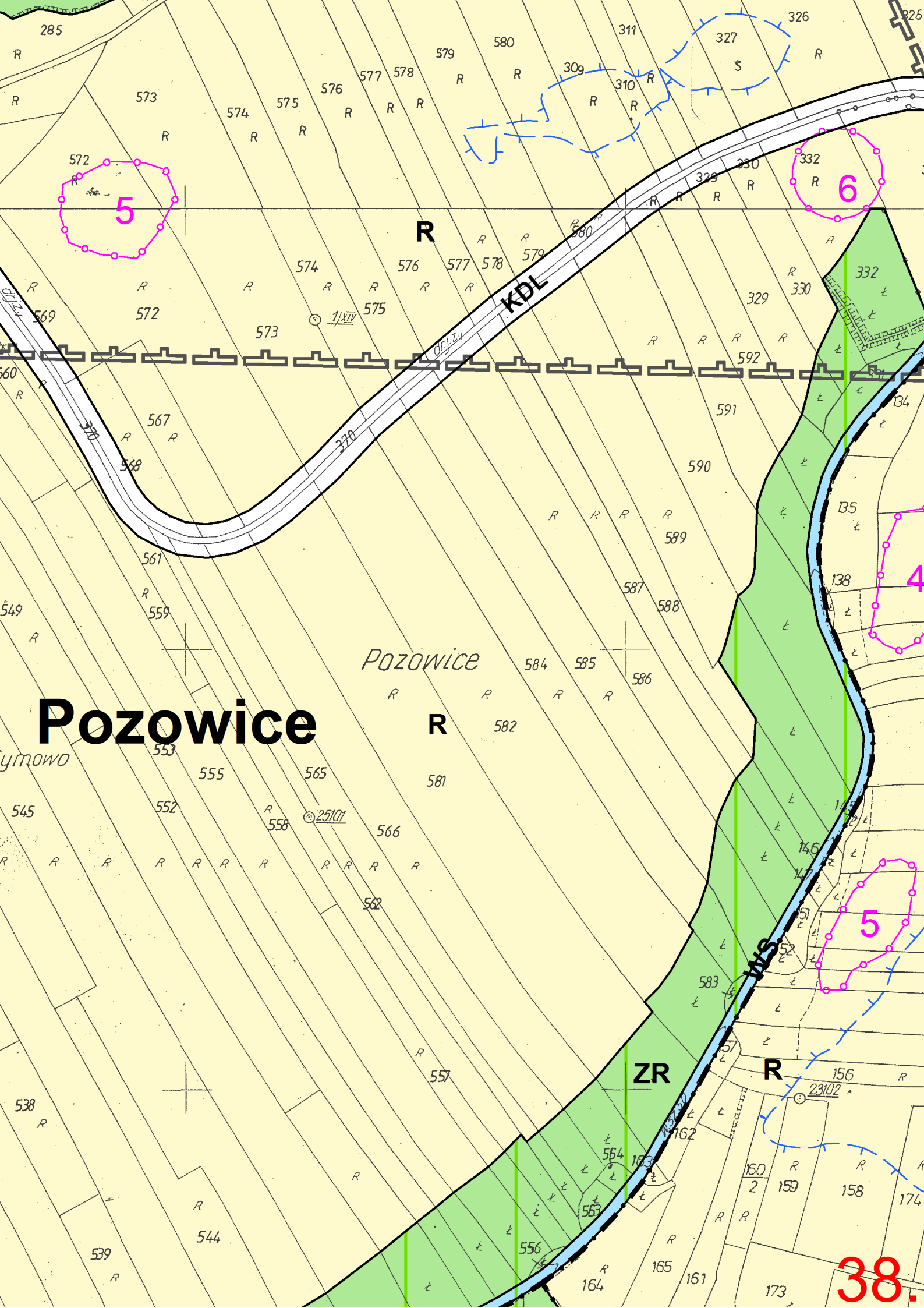

Pozowice

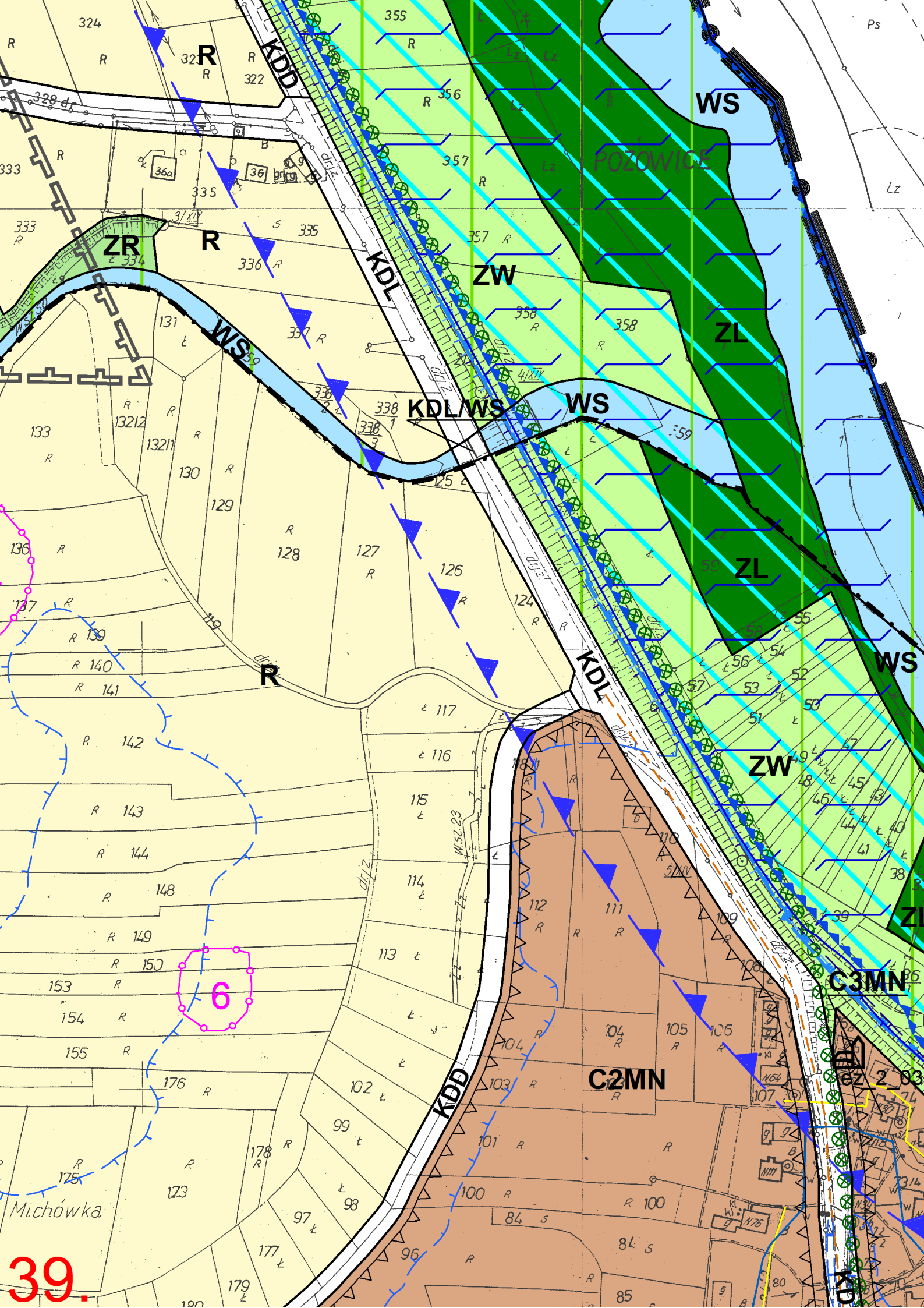

39.

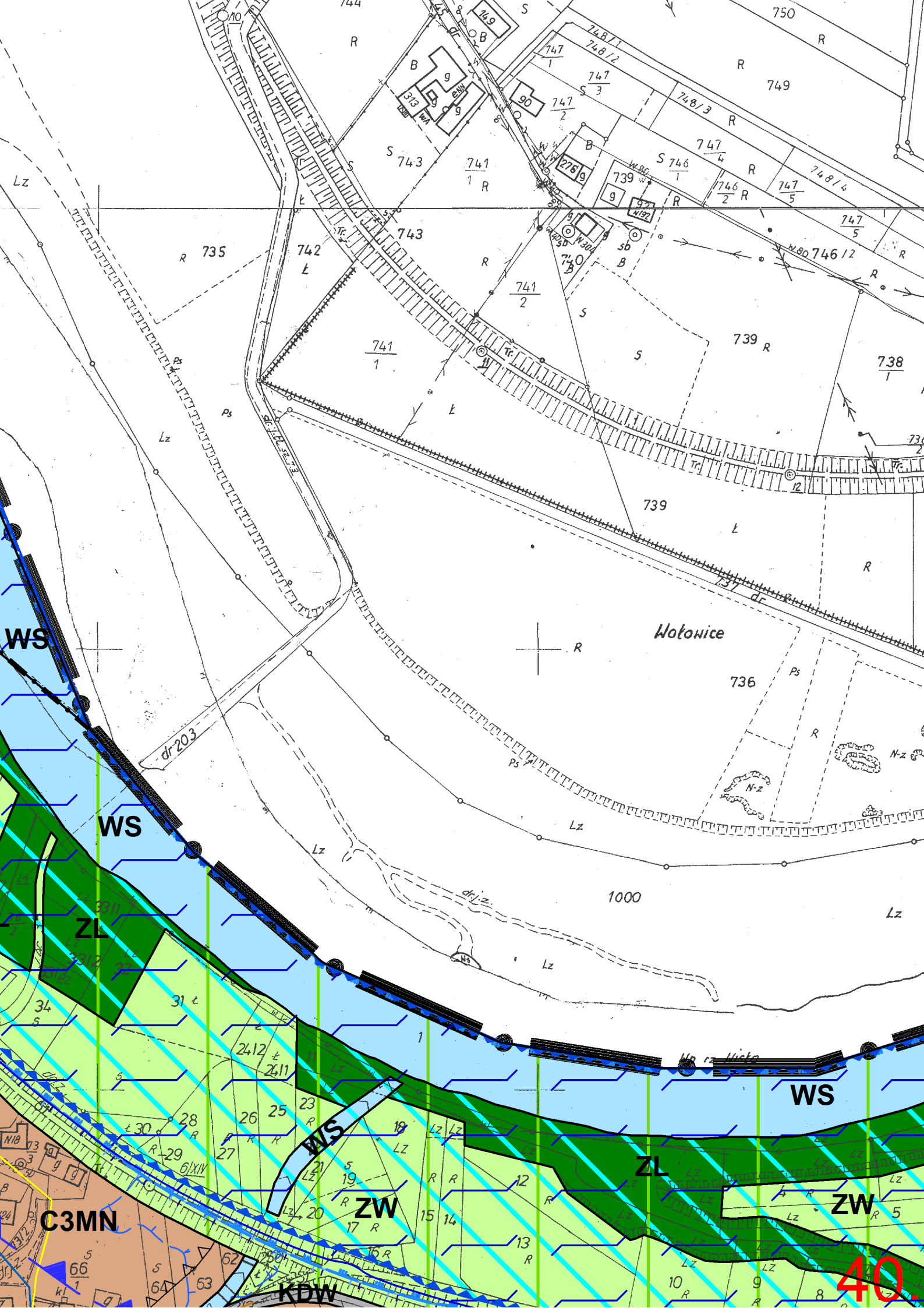

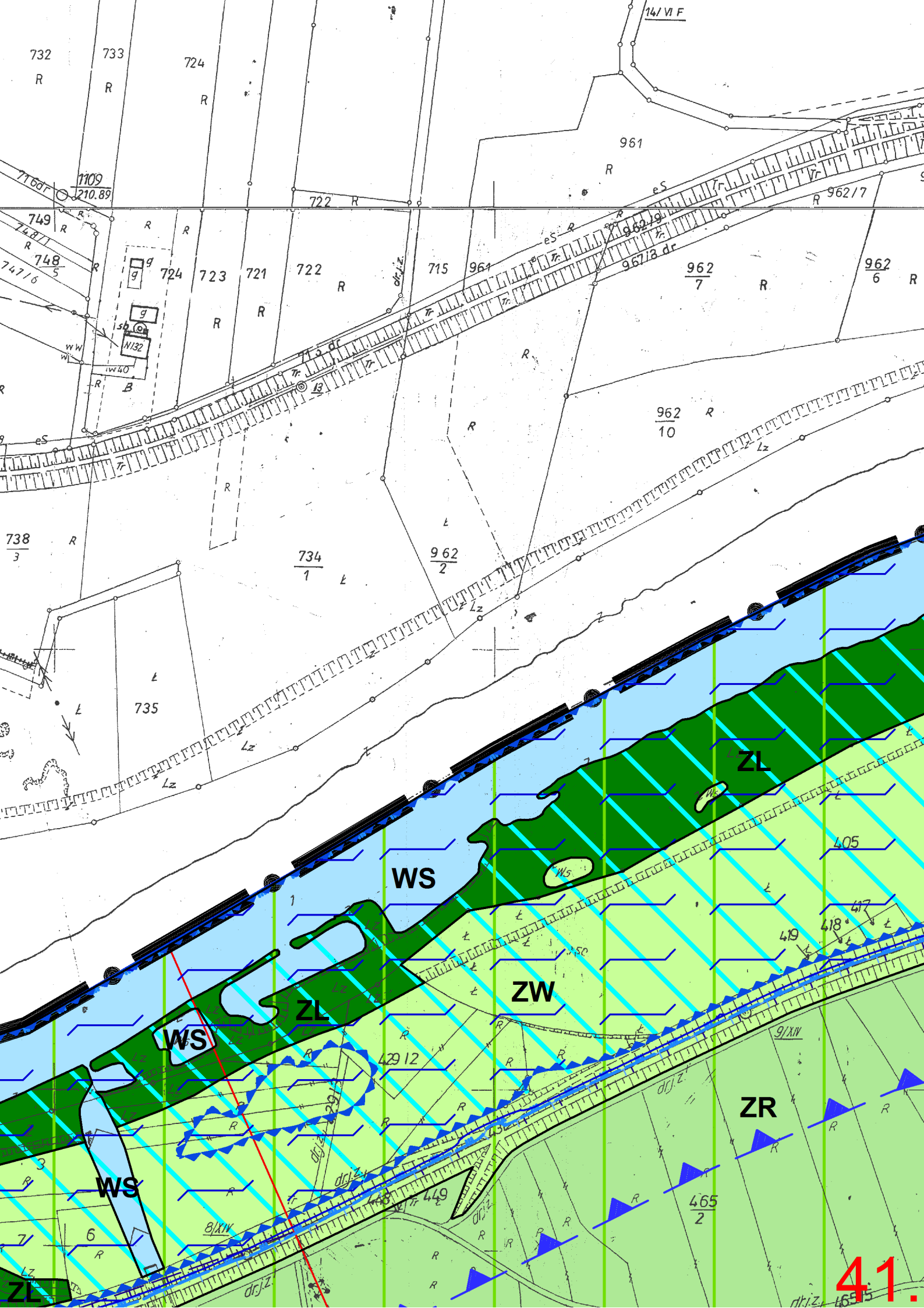

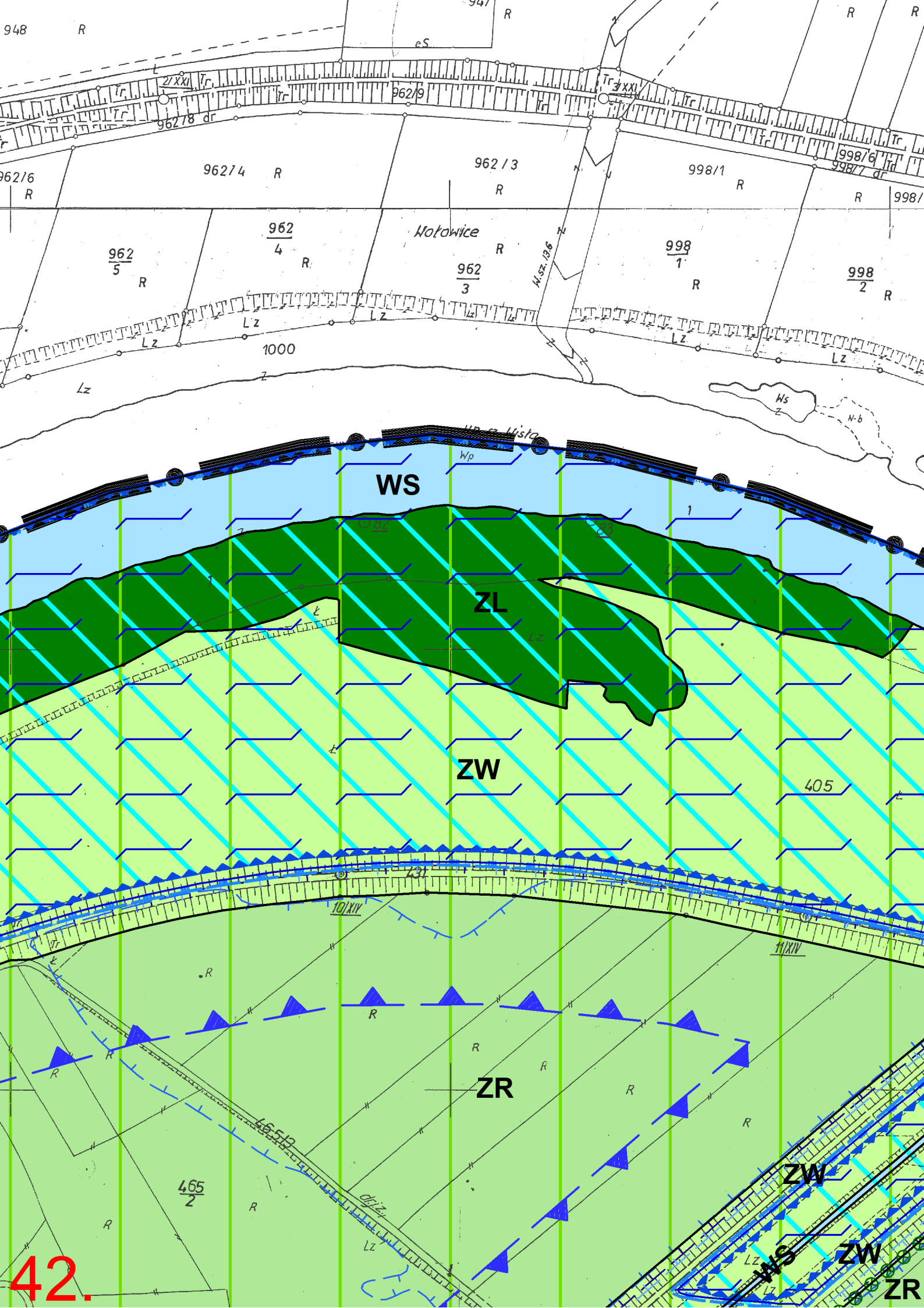

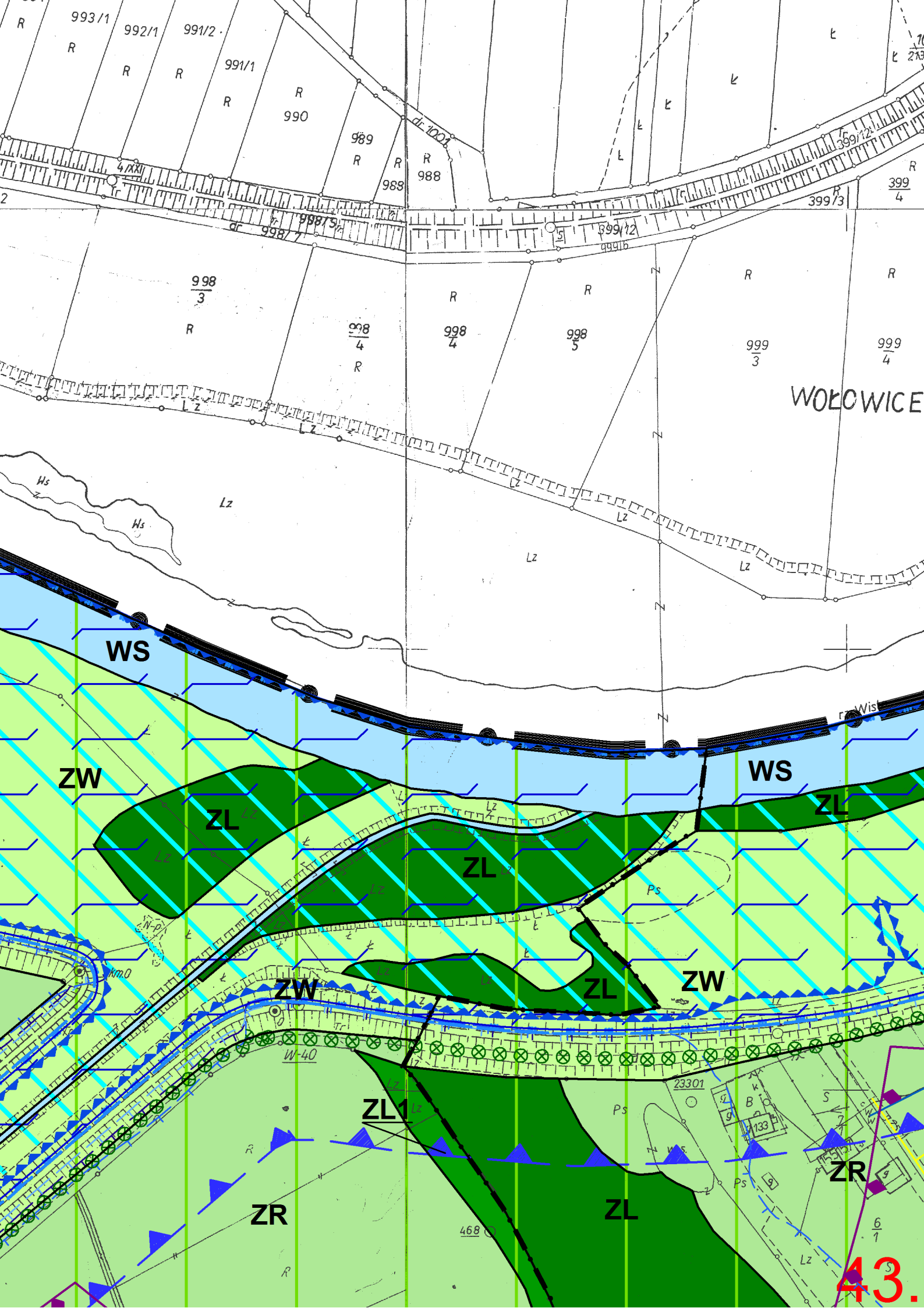

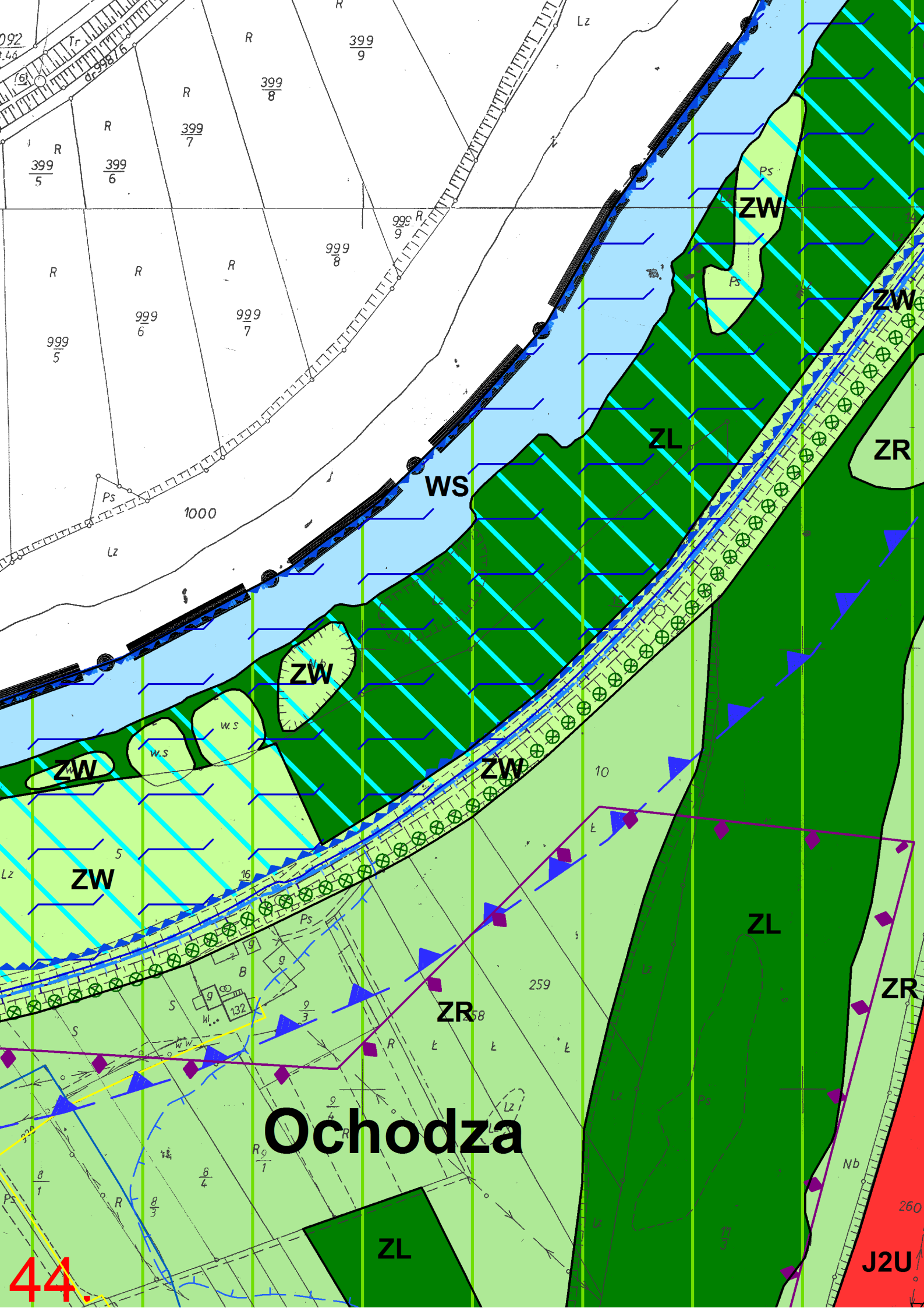

Ochodza

44.

J2U

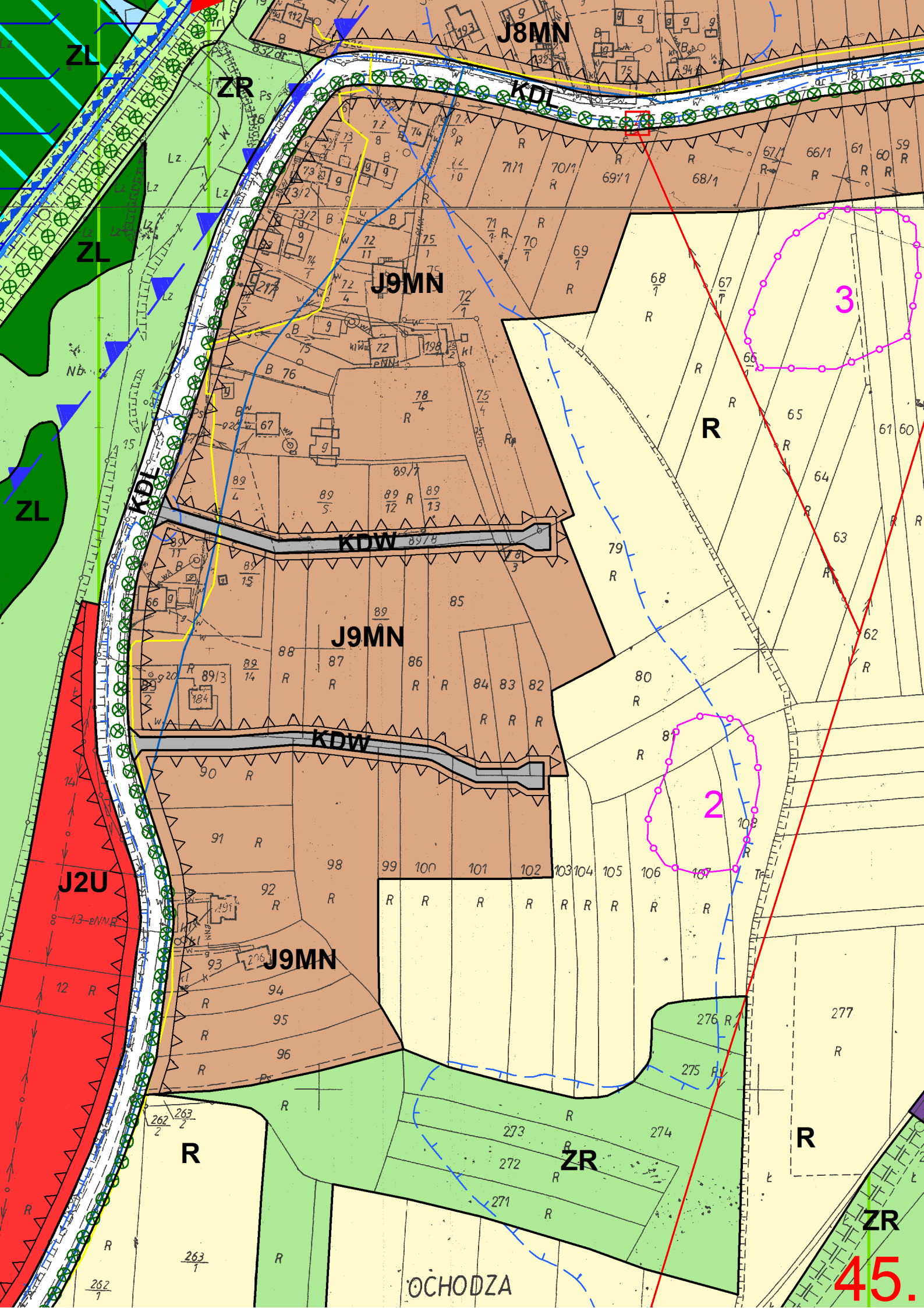

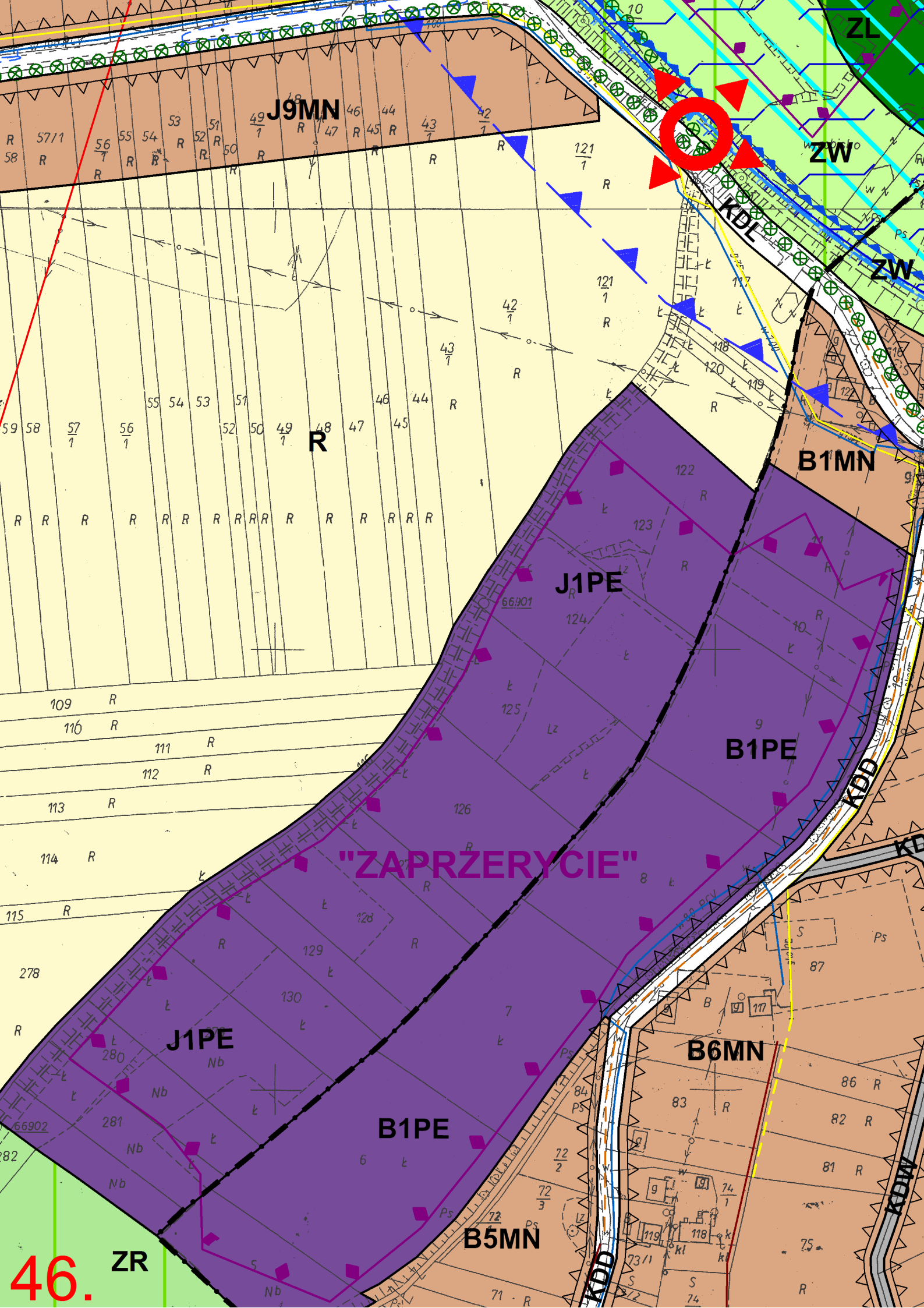

J9MN

ZW

ZW

B1MN

J1PE

B1PE

"ZAPRZERYCIE"

J1PE

B1PE

B6MN

B5MN

ZR

46.



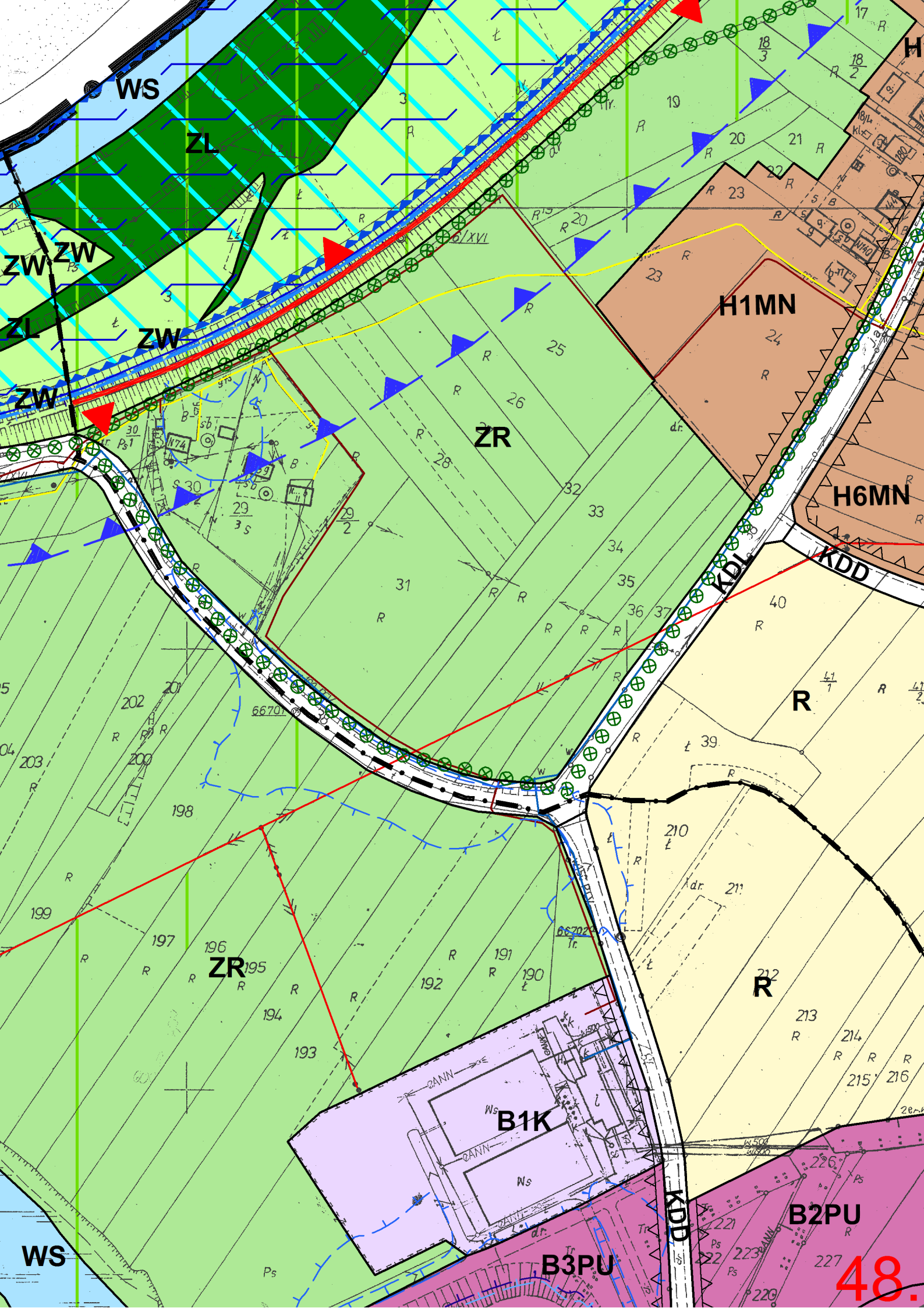

[illegible]

1MN

H2MU

H4MU

H3MU

KDD

H5MN

H6MN

KDD

H9MN

Kopanka

R

B2PU

B1PU

49.

[illegible][illegible]

The image is a complex cadastral map of a residential area named "Kopanka R". It features several distinct zones and individual land parcels. Key elements include:

- Zones and Labels:** Various areas are labeled with codes such as H1MN, H2MU, H3MU, H4MU, KDD, H5MN, H6MN, H9MN, B2PU, and B1PU. These likely represent different types of land use or ownership.
- Central Area:** A large central section is prominently labeled "Kopanka R".
- Highlighted Features:** A small red rectangular box highlights a specific parcel located between the H6MN and H9MN zones. Additionally, a pink-outlined polygon labeled with the number "6" is situated in the lower-middle part of the map.
- Infrastructure:** The map depicts a network of roads, some shown as solid black lines and others as dashed blue lines. Numerous small numbers (e.g., 50, 51, 52, 53, 54, 55, 56, 57, 58, 59, 60, 61, 62, 63, 64, 65, 66, 67, 68, 69, 70) are scattered throughout, representing individual plots or lots.
- Other Details:** The map includes various symbols for buildings, fences, and other geographical features. Some areas are shaded in light green or yellow, possibly indicating parks or undeveloped land.

[illegible]

